

90 mm Glass Filtration Apparatus



WATCH VIDEO

121°C / 1bar / 20 min



VF 15



VF 16

Features

- Filter and store directly in GL45 bottle. No cross-contamination.

Applications

Purification of organic, corrosive liquid such as solvent, mobile phase for HPLC, GC and AA analysis.

* VF 15 membrane support may not withstand strong acids. Refer to the chemical compatibility chart before use.

* VF 17 is similar to VF 16 but features a 3500 mL laboratory glass bottle.

Specification

Material	VF 15	VF 16
Funnel	Borosilicate glass	Borosilicate glass
Support base	Borosilicate glass	Borosilicate glass
Membrane support	SS screen with PTFE gasket	Sintered glass
Clamp	Aluminum	Aluminum
Filtration adaptor	PP	PP
Storage bottle	Borosilicate glass	Borosilicate glass

Specification

Funnel capacity	1000 mL	1000 mL
Bottle capacity	5000 mL	5000 mL
Filter diameter	90 mm	90 mm
Effective filtration area	45.5 cm ²	45.5 cm ²
Hose barb	ID4 ~ ID8	ID4 ~ ID8

* The bottle withstands nearly full vacuum for use in vacuum filtration.

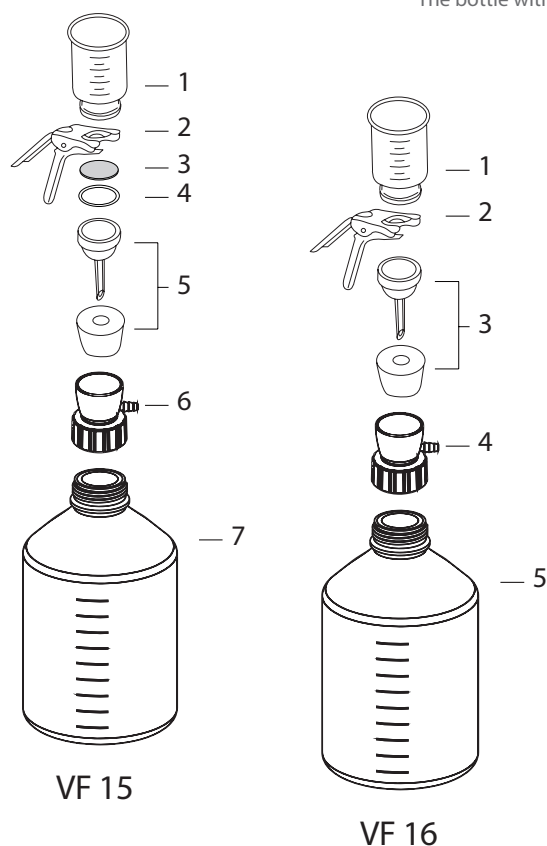

VF 15

VF 16

Ordering Information

Glass Filter Holder (1000 mL)		167200-15
Glass Filter Holder (1000 mL)		167120-37
1	Glass funnel, 1000 mL	167210-10
2	Aluminum clamp, 90 mm	167240-02
3	SS support screen, 90 mm	167230-33-1
4	PTFE gasket, 90 mm	167230-43
5	Glass support base, 90 mm (Including No.8 silicone stopper)	167230-10
6	GL45 filtration adaptor	197000-65
7	Laboratory glass bottle, 5000 mL	197000-55
VF 16, 90 mm Glass Filtration Set		167200-16
Glass Filter Holder (1000 mL)		167120-38
1	Glass funnel, 1000 mL	167210-10
2	Aluminum clamp, 90 mm	167240-02
3	Sintered glass support base, 90 mm (Including No.8 silicone stopper)	167230-11
4	GL45 filtration adaptor	197000-65
5	Laboratory glass bottle, 5000 mL	197000-55