

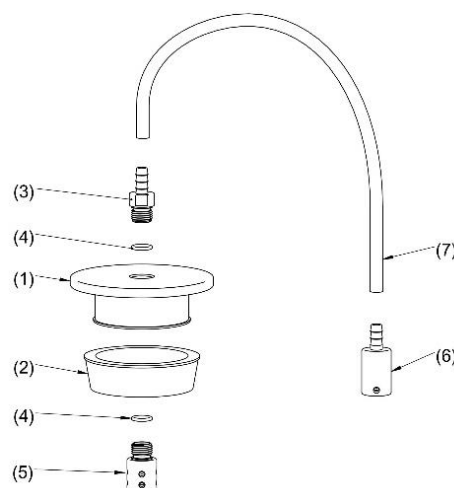

Rocker's continuous filtration kit is designed to help large volume liquid filtration and compatible with Rocker's 300 ml glass funnel, such as VF 3, VF 6, VF 7, and VF 12. The main material of this product is PTFE (item 1, 3, 5, 6) which is chemical resistance. Carefully check if the shipping carton is damaged before unpacking. Please check the items according to package list. If you have any question, please preserve serial no. & shipping carton and contact your dealer for quick solution.

Item	Assembly	Item	Assembly
1	Funnel Lid	5	Buffering Hose Barb
2	Gasket Seal	6	Sinker
3	Inlet Hose Barb	7	Silicone Tube, Ø 6 x 12 mm, length 1 m
4	O-ring		



## Assembling

**Assembling** (Please follow the above diagram to install the continuous filtration kit)

1. Insert the inlet hose barb and buffering hose barb to funnel lid. (Fig 1.)
2. Install the assembled funnel lid to 300 ml glass funnel and press slightly to seal it. (Fig 2.)
3. Connect the silicone tube to inlet hose barb and sinker, place the sinker to the solution.  
\* Place the sinker in the solution deeply in order to suck liquid as much as possible.
4. Turn on the pump and start a filtration.



Fig 1.

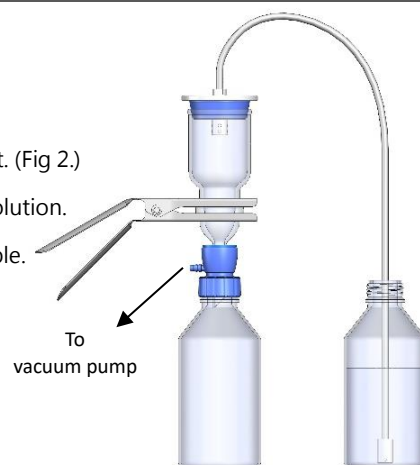

Fig 2.

## Maintenance

1. Please clean or autoclave the kit before using.
2. Screw the hose barbs into funnel lid carefully to avoid any damage.
3. To prevent air leakage and improve the efficiency, slightly press the funnel lid when a filtration is started.
4. Please avoid suck the air during filtration if the suction of pump is less than bubble-point pressure of membrane.

## Ordering Information

167210-36	Continuous Filtration Kit	167210-36-5	Sinker
167200-38	Silicone Tube, Ø 6 x 12 mm, length 1 m	167200-12	VF 12, Glass Filtration Set