

How to use : WelVac 200 / 210

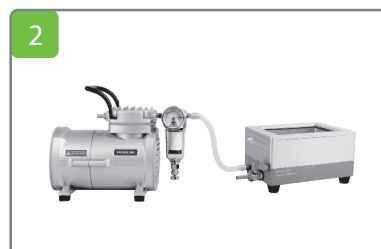

1
Put the upper chamber on the top of lower chamber with waste tray in it.



2
Connect the WelVac 200 and vacuum pump together with silicone tube.
• Adjust the vacuum with pump regulator before operation.

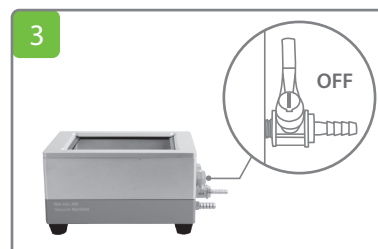

3
Make sure the vent is **closed** and choose spin columns or 96-well plate for extraction.

➡ Spin columns



4-1a
Place the column adaptor board on the gasket of upper chamber.

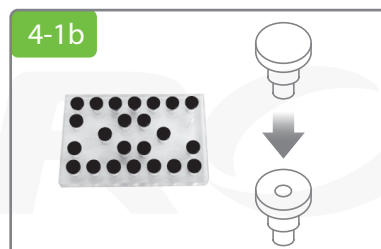

4-1b
Replace the Luer stoppers with Luer connectors which the number is same as spin columns.

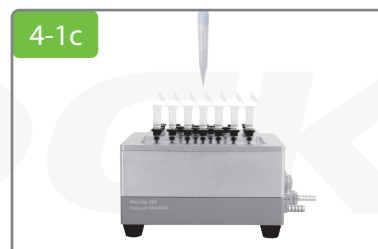

4-1c
Insert the spin columns firmly to Luer connectors and load the samples.

➡ 96-well plate



4-2a
Place the 96-well plate on the gasket of upper chamber.



4-2b
Load the samples and ready for extraction.
• Every well should be filled to make sure no air leakage.

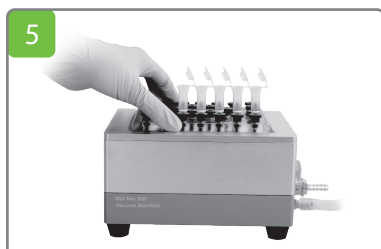

5
Turn on the vacuum pump, press lightly on column adaptor board or 96-well plate to **seal** the top ring and start extraction.

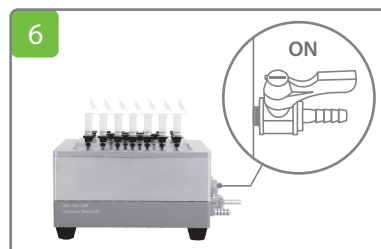

6
Turn off the vacuum pump after extraction and **open** the vent to release the vacuum.

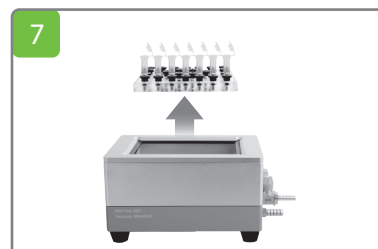

7
Remove column adaptor board or 96-well plate.

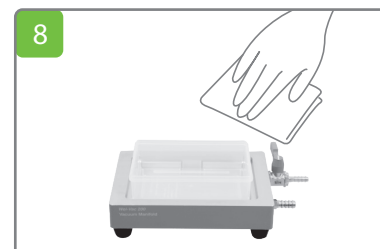

8
Discard the waste and clean WelVac 200 with paper towels.